

## EVAC TRAIN



## EVAC COMPACT VACUUM TOILET



**Evac GmbH**  
Feldstraße 124, 22880 Wedel, Germany  
Tel.: +49 4103 9168 0  
Fax: +49 4103 9168 90  
info@zodiacaerospace.com  
www.evac-train.com, www.zodiacaerospace.com

**EVAC TRAIN**



## EVAC COMPACT VACUUM TOILET

### PROPERTIES

- Micro-processor controlled system with integrated fault detection and correction.
- Compact and space saving design for optimal integration into toilet cabins of newly built trains and also for installation as retrofit units in coach renovation and refurbishment programs.
- Quick and easy installation.
- Only approx. 0.5 liters water consumption per flush. The bowl is flushed with high pressure water.

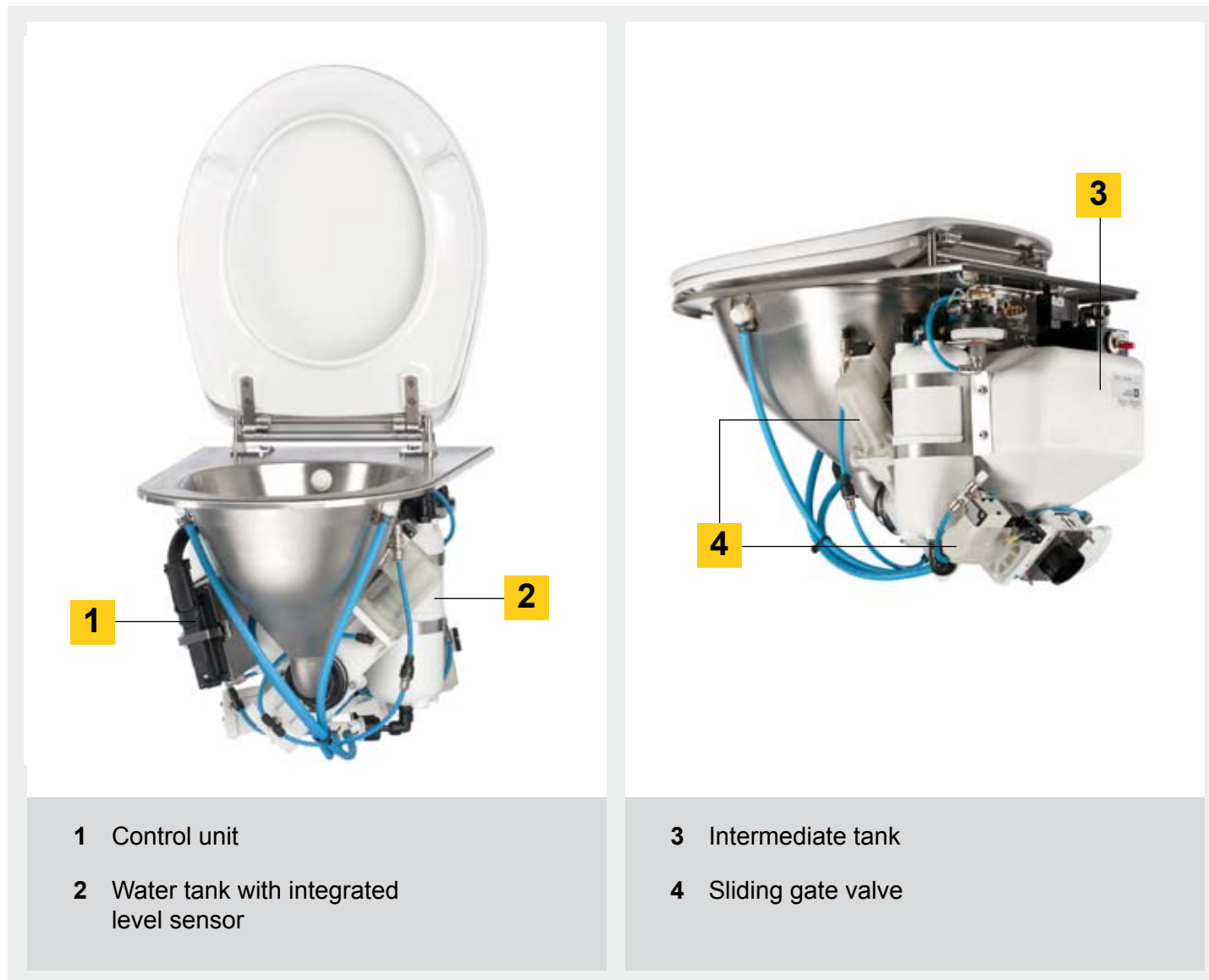

- 1 Control unit
- 2 Water tank with integrated level sensor

- 3 Intermediate tank
- 4 Sliding gate valve

### HOW IT WORKS

When a flush is activated compressed air flows through the vacuum pump (ejector) and a vacuum is created in the intermediate tank. The bowl is rinsed. The inlet valve opens and the content of the bowl is discharged to the intermediate tank. As soon as the valve has closed the system creates over-pressure in the intermediate tank. The outlet valve opens and the content of the intermediate tank is transported to the waste water tank.

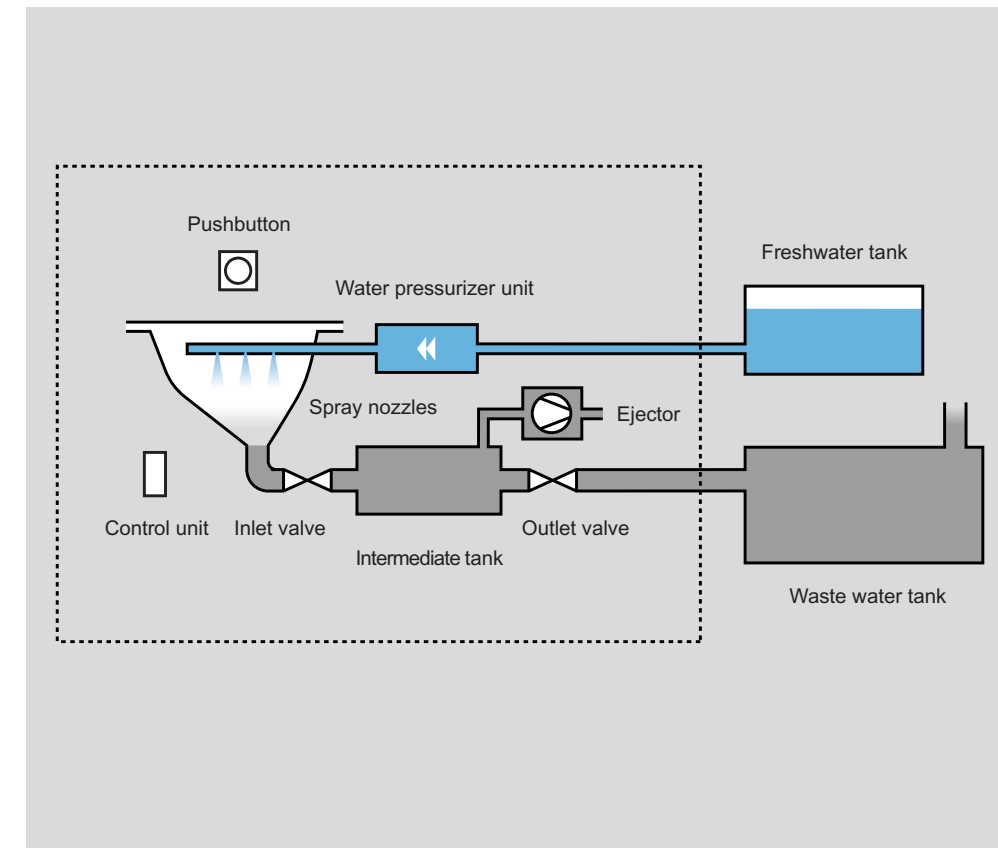

### GENERAL DATA

<b>MEASUREMENTS</b>	Dimensions (mm)	
	without seat:	540 (length) x 365 (width) x 373 (height)
	Weight:	15 kg dry
<b>MATERIAL</b>	Intermediate tank:	PE
	Bowl assy:	Stainless steel
<b>SUPPLIES</b>	Compressed air:	6.2 bar, filter: 7 µm max. grain size
	Water:	0.1 – 1.5 bar, filter: 350 µm max. grain size
	Voltage:	24 V DC (+/- 30 %)
<b>CONSUMPTION</b>	Air:	approx. 28 liter expanded air per flush
	Water:	approx. 0.5 liter per flush
	Electric power:	2.2 W (stand-by) – 12 W (during flush)

