

## EVAC TRAIN



## EVAC ONLINE VACUUM TOILET



**Evac GmbH**  
Feldstraße 124, 22880 Wedel, Germany  
Tel.: +49 4103 9168 0  
Fax: +49 4103 9168 90  
info@zodiacaerospace.com  
www.evac-train.com, www.zodiacaerospace.com



## EVAC ONLINE VACUUM TOILET

### PROPERTIES

- The latest development in the Evac Vacuum Toilet System family is the EVAC ONLINE. The new concept is an optimal solution developed for both new coaches and refurbishment programs. The new Evac Online System can easily be combined with a wide range of different Evac standard components and will meet most customer specifications and requirements. The system shows a high grade of reliability, because most of the components are experienced and have been in the assortment for several years.
- All system components are made for easy adaption to the coach.
- The flush volume is approx. 0.5 liters only per flush cycle.
- The total air consumption per flush is limited to 70 liters air.
- Several toilets can be connected to one common system.
- Different types of toilets can be selected for the system.

## HOW IT WORKS

- Intermittent vacuum principle. Vacuum is created in the piping only. Direct waste transport from the toilet to the tank, which has constant atmospheric pressure.
- Pushing the flush button the ejector creates a strong suction power in the piping between toilet and ejector.
- The water pressurizer is activated and the bowl is rinsed.
- The toilet outlet valve opens for evacuation to the retention tank.

The Evac Online system can be equipped with a wide range of alarms and system indicators.

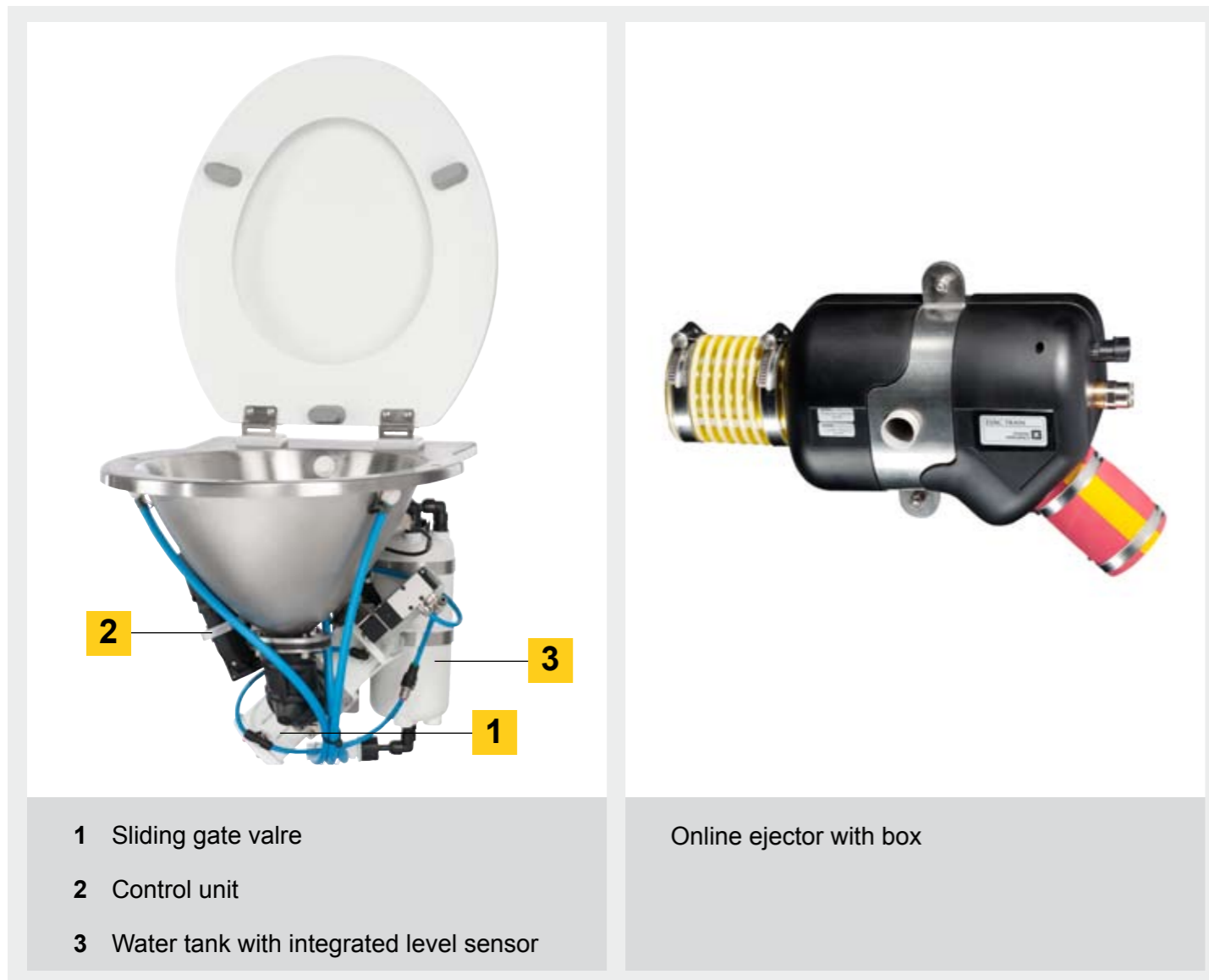
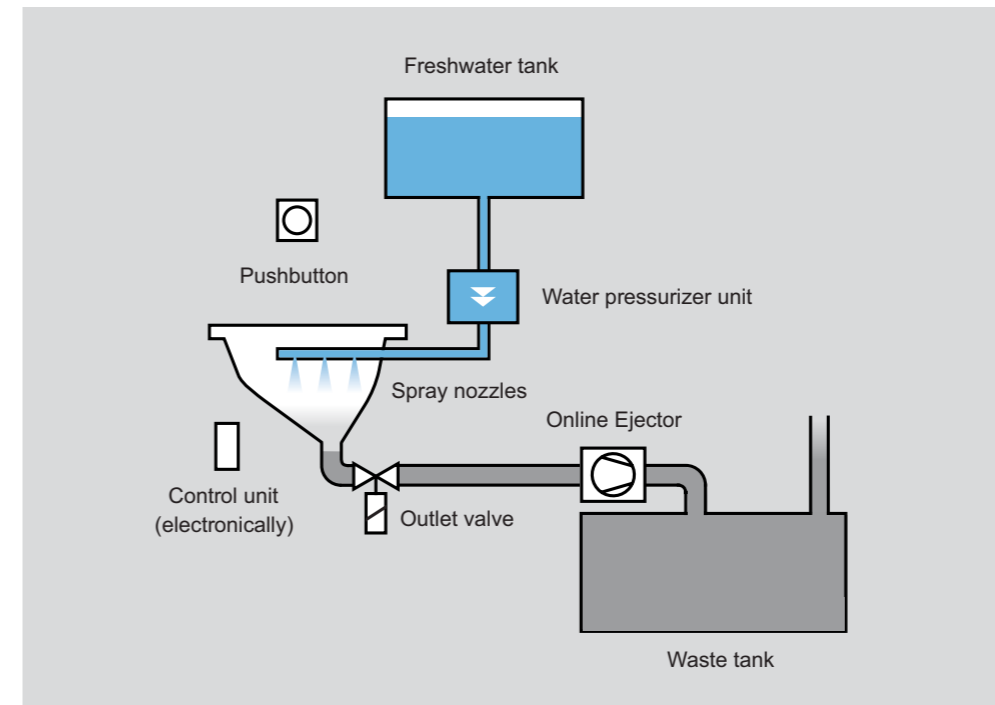

- 1 Sliding gate valve
- 2 Control unit
- 3 Water tank with integrated level sensor

Online ejector with box

## GENERAL DATA

<b>MEASUREMENTS</b>	Dimensions (mm) without seat:	different types available
	Max. horizontal piping run (toilet to tank):	tested to 10 m
<b>MATERIAL</b>	Bowl assy:	Stainless steel
<b>SUPPLIES</b>	Compressed air:	620 kPa, min. air flow rate 1400 NI/min
	Voltage:	24 V DC (+/- 30 %)
<b>CONSUMPTION</b>	Air:	approx. 70 liter per flush
	Water:	approx. 0.5 liter per flush
<b>CONNECTION</b>	Air:	G1/4"
	Water:	G1/2"
	Discharge:	Ø 50 mm

